

# USB DisplayPort HDBaseT™ 2.0 KVM Extender (4K@100 m) CE920

- The ATEN CE920 USB DisplayPort HDBaseT™ 2.0 KVM Extender integrates the latest HDBaseT™ 2.0 technologies to deliver 4K video, stereo audio, USB, Ethernet, and RS-232 signals up to 100 meters using a single Cat6 / 2L-2910 Cat 6 cable. The HDBaseT™ 2.0 guarantees the most reliable transmission on the market as well as enables the long-reach capability that extends full HD 1080P signals up to 150 meters. With an easy cable installation supporting various signals, the CE920 is ideal for applications where convenient remote access is required – such as transportation control centers, medical facilities, industrial warehouses, and extended workstations.

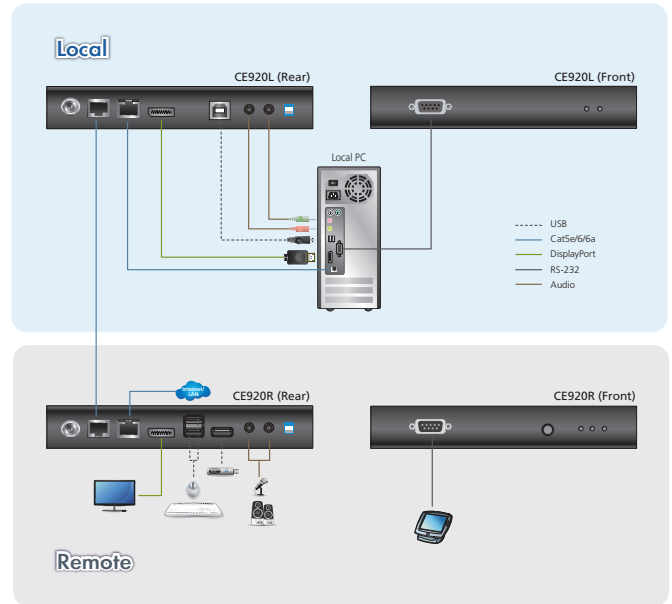

## Specifications

Function	CE920L	CE920R
<b>Connectors</b>		
Console Ports	N/A	1 x DisplayPort Female (Black) 3 x USB Type A Female 1 x Mini Stereo Jack Female (Green) 1 x Mini Stereo Jack Female (Pink) 1 x RJ-45 Female (Black)
KVM Ports	1 x DisplayPort Female (Black) 1 x USB Type B Female (White) 1 x Mini Stereo Jack Female (Green) 1 x Mini Stereo Jack Female (Pink) 1 x RJ-45 Female (Black)	N/A
RS-232	1 x DB-9 Female (Black)	1 x DB-9 Male (Black)
Power	1 x DC Jack with locking	
Unit To Unit	1 x RJ-45 Female (Black)	
<b>LEDs</b>		
Power	1 (Green)	
Link	1 (Orange)	
Video Output	N/A	1 (Orange)
<b>Switches</b>		
Long Reach Mode Switch	1 x Slide Switch	
Firmware Upgrade	1 x Slide Switch	
<b>Pushbuttons</b>		
Wakeup button	N/A	1 x Push button
<b>Video</b>	Up to 4K @ 90m (Cat 5e) / 100m (Cat 6/6a/ATEN 2L-2910 Cat6) 1080P @ 100m (Cat 5e/6/6a) <b>*4K supported:</b> 4096 x 2160 / 3840 x 2160 @ 30Hz (4:4:4)	
Power Consumption	DC5V: 3.99W: 19BTU	DC5V: 6.74W: 47BTU
<b>Environmental</b>		
Operating Temperature	0° - 40° C	
Storage Temperature	-20° - 60° C	
Humidity	0 - 80% RH, Non-condensing	
<b>Physical Properties</b>		
Housing	Metal	
Weight	0.63 kg	0.64 kg
Dimensions (L x W x H)	18.20 x 12.19 x 2.87 cm	

Note: DisplayPort v1.1 supports up to 4K x 2K @ 30Hz

Product information is subject to change without prior notice.



## Features

- Supports HDBaseT™ 2.0 technology
  - Extends video, audio, USB, RS-232, and Ethernet signals via a single Cat6 / 6a / 2L-2910 Cat 6 cable
  - Enhanced bit error detection and correction to resist signal interference during high-quality video transmissions
  - Status detection and LED indication for HDBaseT™ signal transmission on remote unit
- EDID Buffer for smooth power-up and the highest quality display
- Long distance with superior video quality
  - HDBaseT™ Standard mode up to 4K @ 100m (Cat 6 / 6a / 2L-2910)
  - HDBaseT™ Long-Reach mode up to 1080P @ 150m
- Long Reach mode switch – switches between HDBaseT™ Standard and Long Reach modes in a snap
- USB 2.0 full speed ports – ensures fast transmission speeds for peripherals
- HDCP Compatible
- Supports individual 2-channel stereo audio for high-quality audio applications
- Supports PC wakeup function via single pushbutton through RS-232 channel\*
- Built-in 8KV / 15KV ESD protection (Contact voltage 8KV; Air voltage 15KV)

\* The computer has to support Wake Up Ring for this function to work

### ATEN International Co., Ltd.

3F, No. 125, Sec. 2, Datong Rd., Sijhih District., New Taipei City 221, Taiwan  
Phone: 886-2-8692-6789 Fax: 886-2-8692-6767  
www.aten.com E-mail: marketing@aten.com

Publish Date: 08/2020 V2.0



© Copyright 2020 ATEN® International Co., Ltd.  
ATEN and the ATEN logo are trademarks of ATEN International Co., Ltd.  
All rights reserved. All other trademarks are the property of their respective owners.